

REFERENCE

- D DOOR 3'-0" x 6'-6"
- D₁ " 2'-6" x 6'-0"
- W WINDOW 3'-0" x 4'-0"
- V VENTILATOR 2'-6" x 1'-6"

BRICK 100 CM 1:2 AND PLASTERED WITH CM 1:4. 12" TH TO ALL THE EXPOSED PORTION & CHIMNEY

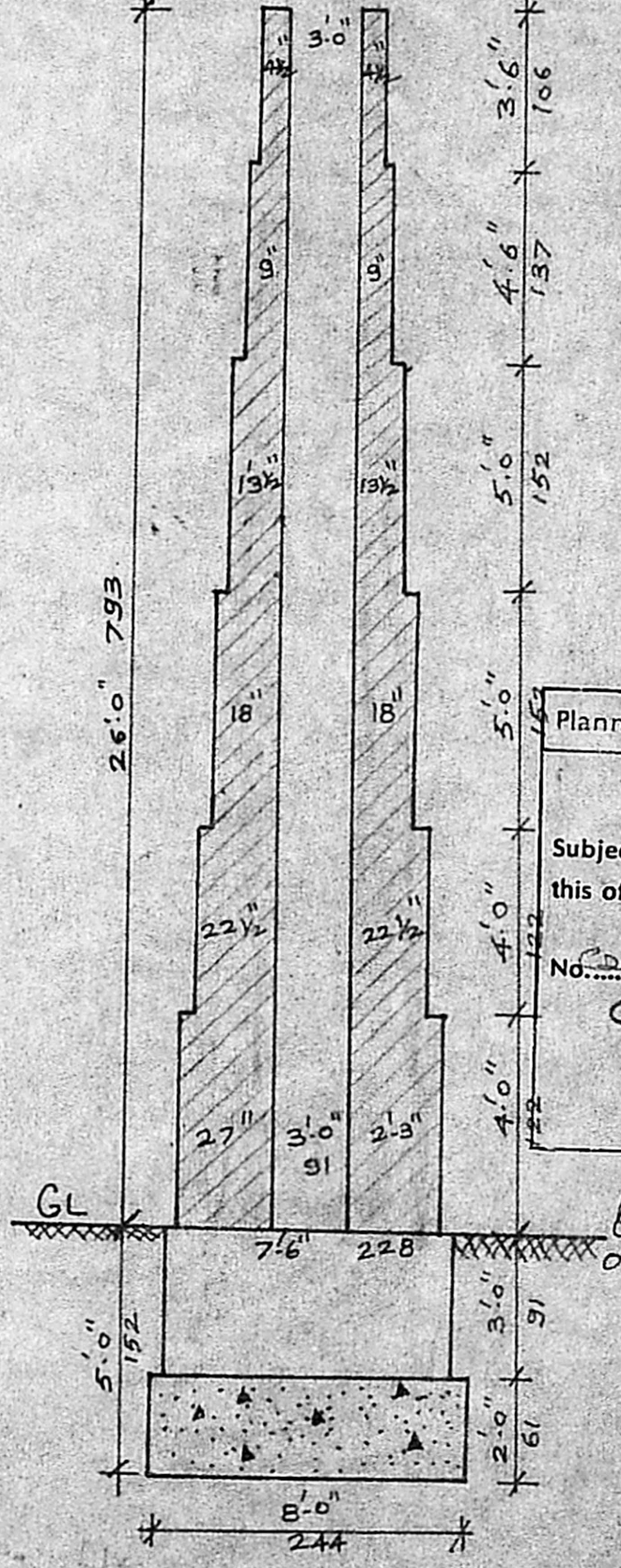
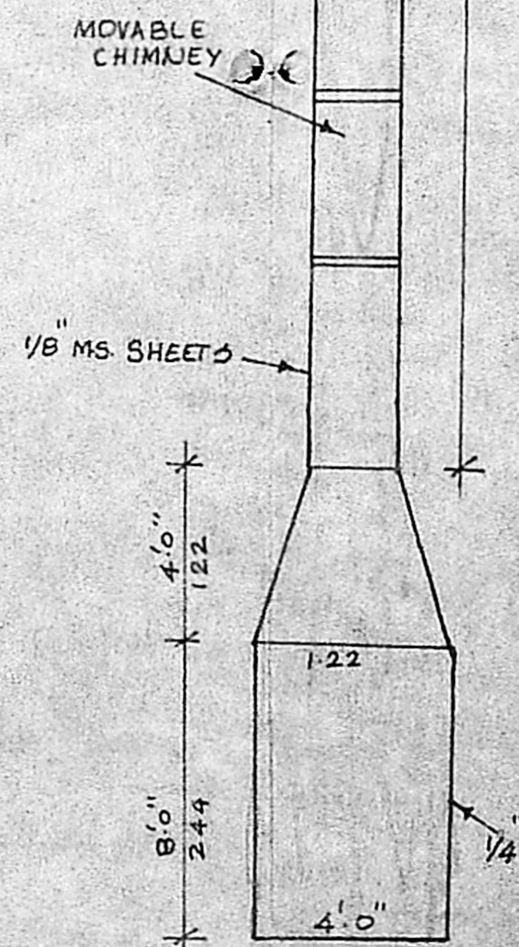
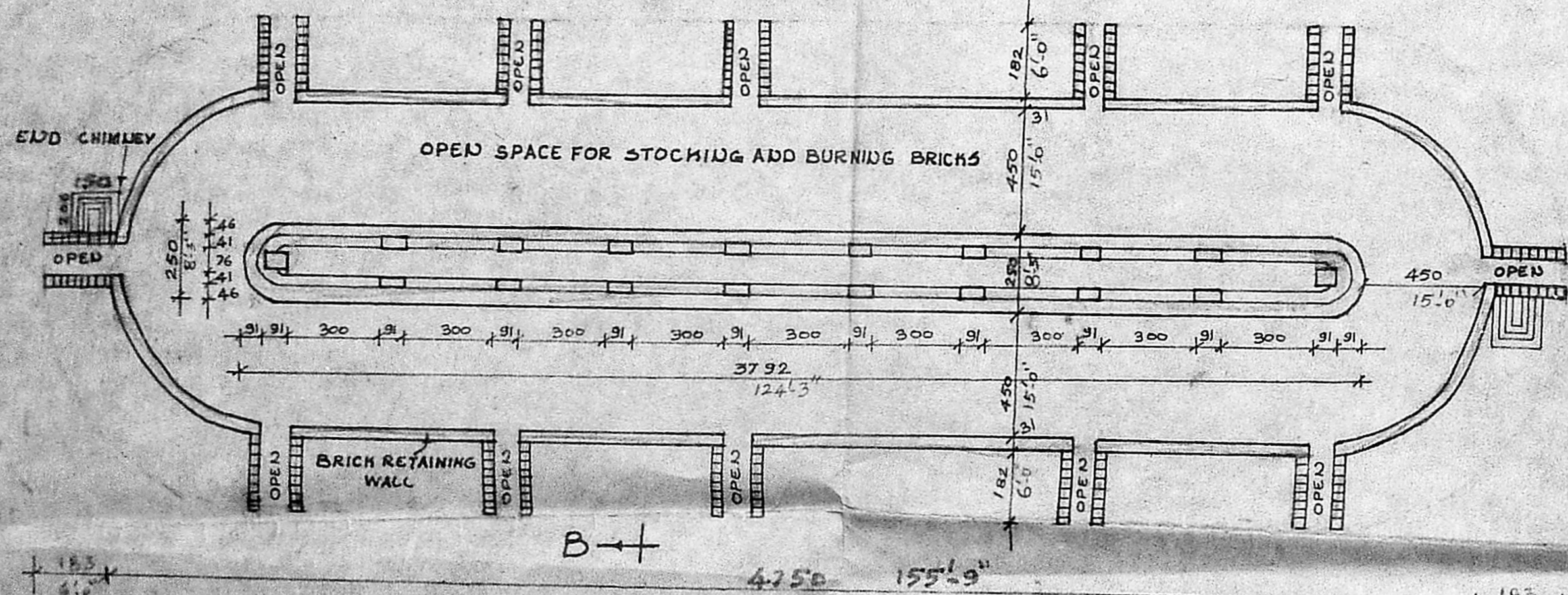
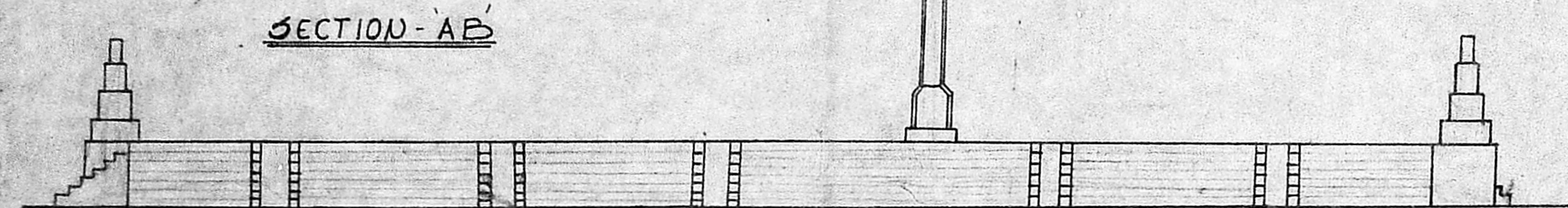
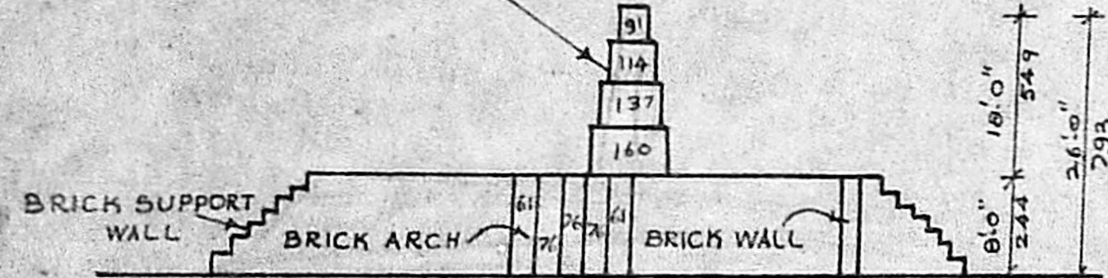

PLAN SHOWING PROPOSED BRICK CHAMBER IN S.N. 105, 109 & 110, MEPPUR VILLAGE (V.N. 75) POUAMALLEE PANCHAYAT UNION, SRIPERUMBUDUR TALUK, CHANGAI ANNA DIST.

FOR SREE KAMADENU BRICK INDUSTRIES

V.N. 75-MEPPUR VILLAGE	S.N.	AREA AC	CE
	105	0-75	
	109	0-60	
	110	0-95	
	TOTAL	2-30	

OR (0.92 HEC)

Planning Clearance No. CP.P.P. 35/20...
APPROVED
Subject to the conditions in this office letter
No. 2239/19 Dt. 02.02.19
S. Durai Pandian
FOR MEMBER SECRETARY,
MADRAS METROPOLITAN DEVELOPMENT AUTHORITY

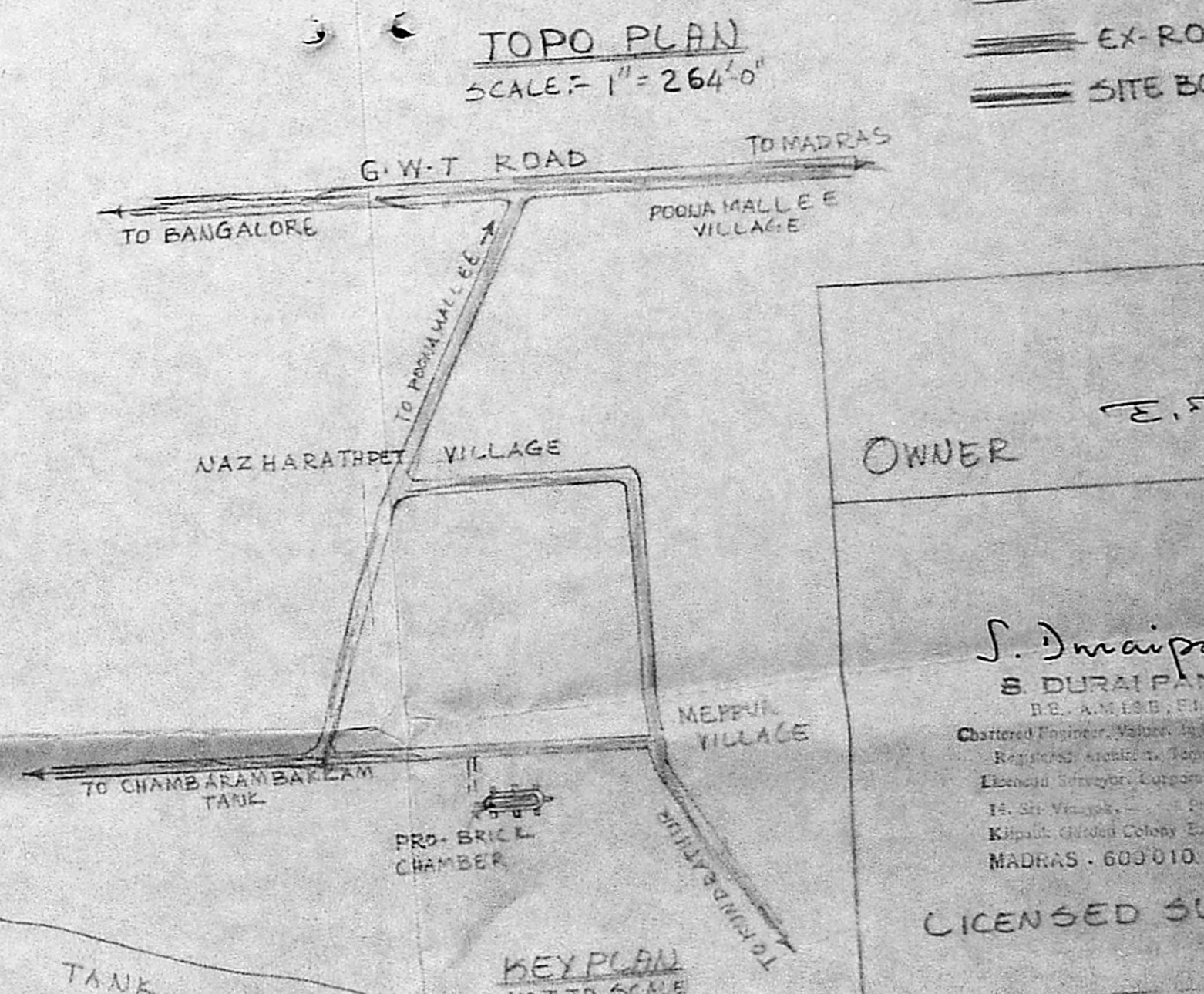
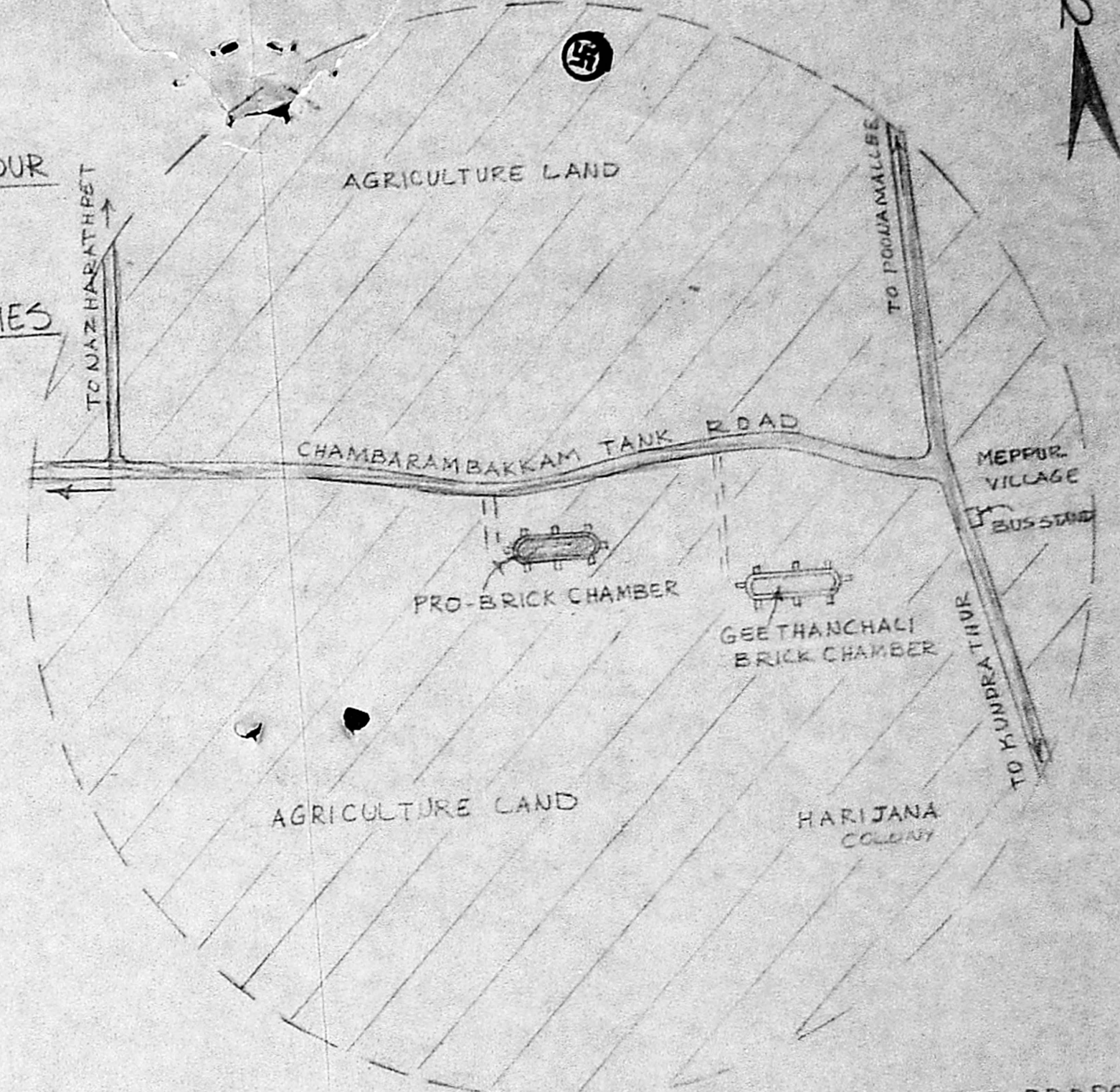
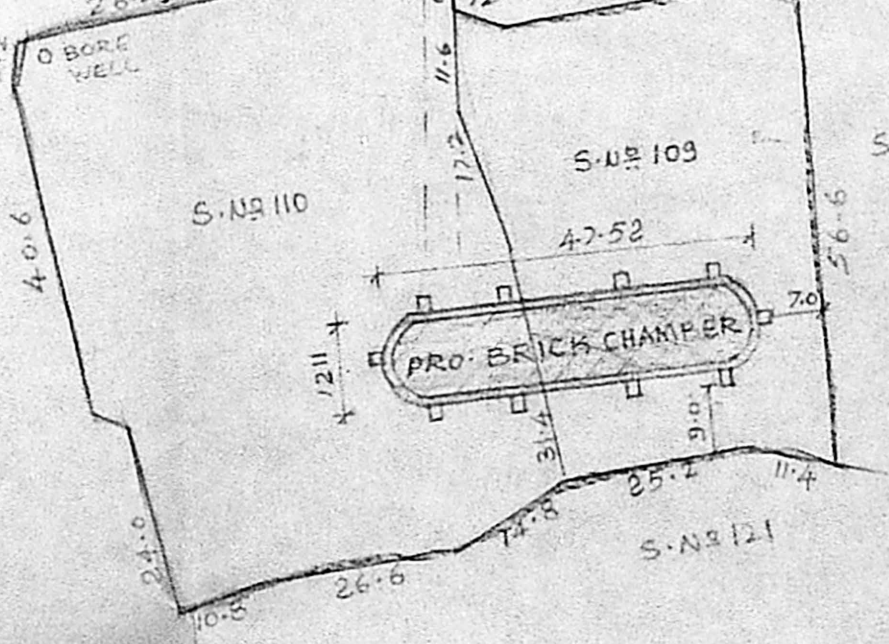

PROPOSAL
EX-ROAD
SITE BOUNDARY

OWNER
S. Durai Pandian
S. DURAI PANDIAN
B.E., AM.E.S.B., P.H. Arch.
Chartered Engineer, Valuer, Industrial Consultant
Registered Architect, Town & Country Engineer & Licensed Surveyor, Corporation of Madras
14, Sri Venkateswara Street, Meppur, Chennai-600010
MADRAS - 600010
LICENSED SURVEYOR